

TANGLEWOOD CR.

33-E  
31.79 a.

MACOGDOCHES COUNTY  
ROAD & BRIDGE  
DEPT. HEADQUARTERS

32-D

18

17-K  
6.396 a.

HUMPHREY ROAD

54

34-  
5.8

32

32-A-10

32-A-9

32-A-8

32-A-7

32-A-6

32-A-5

32-A-4

32-A-3

32-A-2

32-A-1

19 Plus (+)  
Acres  
32  
+  
32-D

34-B-1

17-L  
6 a.

34  
D

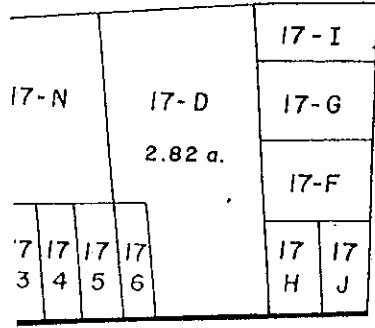

33-A

33

33  
B

33  
D

33  
C

STATE HWY. 7

MARILYN ST.

MARILYN S/D (373)

STATE HWY.

63